



BIALOSKY
CLEVELAND

July 15, 2019

SHAKER HEIGHTS
PUBLIC LIBRARY



LIBRARIES WERE....

Libraries were **repositories**



Libraries were **transactional**



Libraries were **quiet**

SILENCE
IS REQUESTED
— IN THE —
READING ROOM



Libraries were **solitary**



Libraries were **monumental**





LIBRARIES ARE CHANGING

Libraries are still relevant in the 21st century



In 2013, there were **1.5 billion in-person visits to public libraries** across the U.S., the equivalent of more than 4 million visits each day.

There were **96.5 million attendees at public library programs** in 2013, more than all Major League Baseball and NBA games combined.

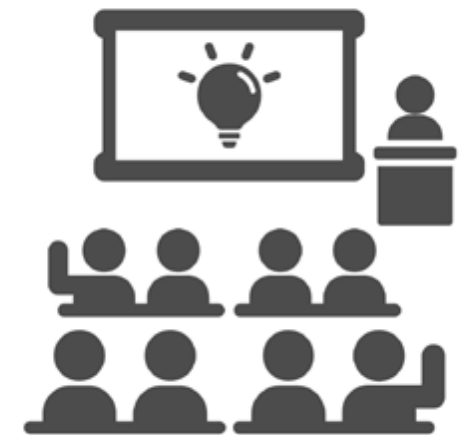

What are 21st century libraries?



Libraries are **play rooms**



Libraries are **maker spaces**



Libraries are **safe spaces**



Libraries are **art galleries**



Libraries are **co-working spaces**



Libraries are **on your mobile device**



Libraries are **online 24/7**



Libraries are **classrooms**

...they are whatever their community needs them to be.

REBALANCE

A rebalancing of space from collections to people allows the library to reinforce a sense of community with engaging gathering spaces that promote interaction.



COLLECTION

VS.



PEOPLE



VS.



REORGANIZE

Reorganizing buildings to be structured around a central gathering area focuses the spatial configuration of the library on the people rather than the collection.

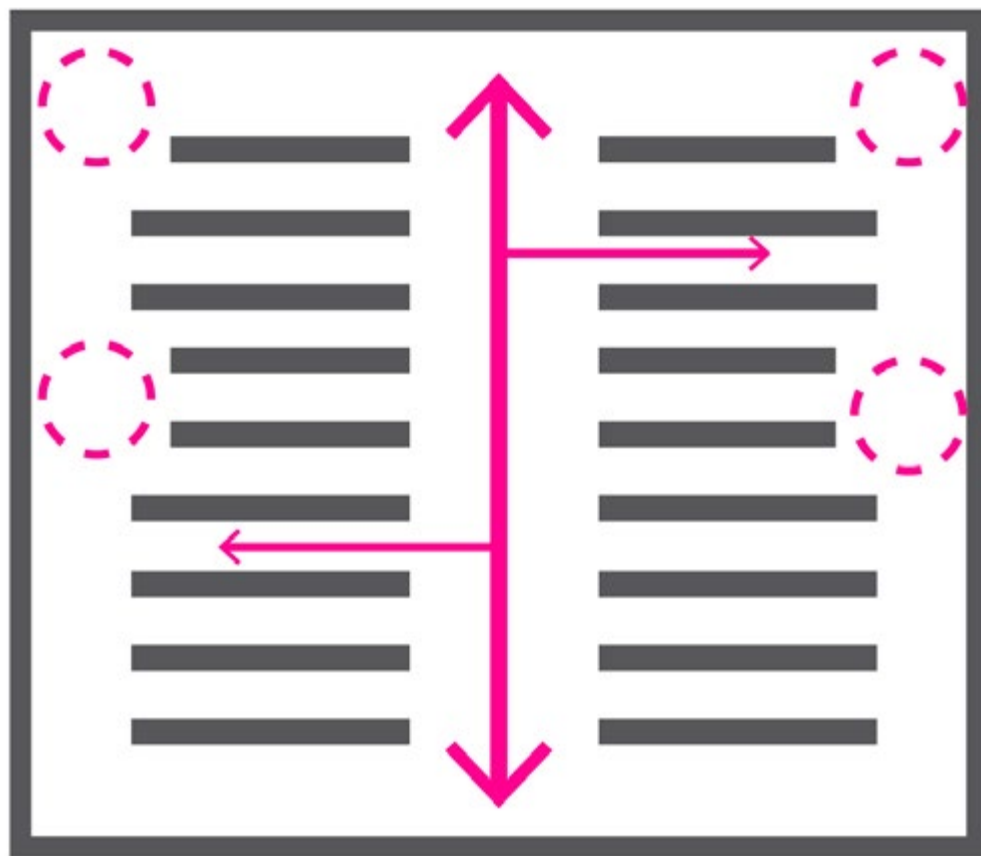

REPOSITORY

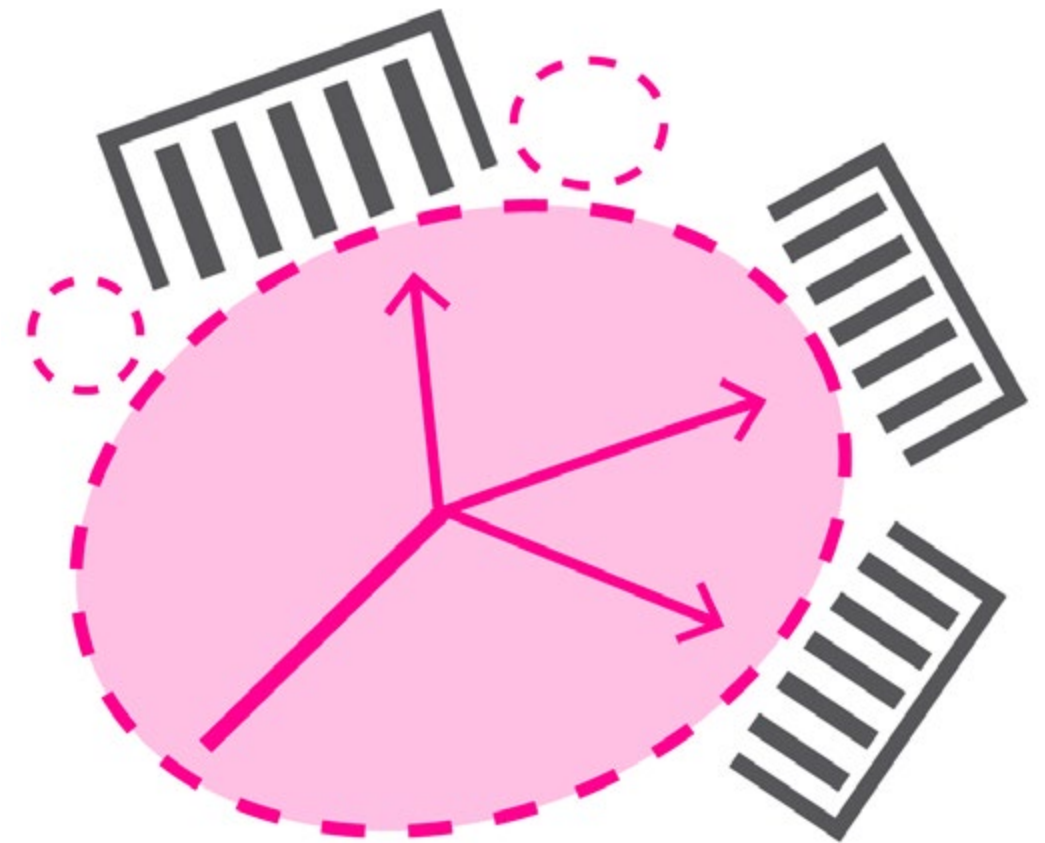

PUBLIC CORE

REMOVE

Removing barriers between people, knowledge, and resources, the library supports inclusive spaces that accommodate learning opportunities for people of all socioeconomic backgrounds.

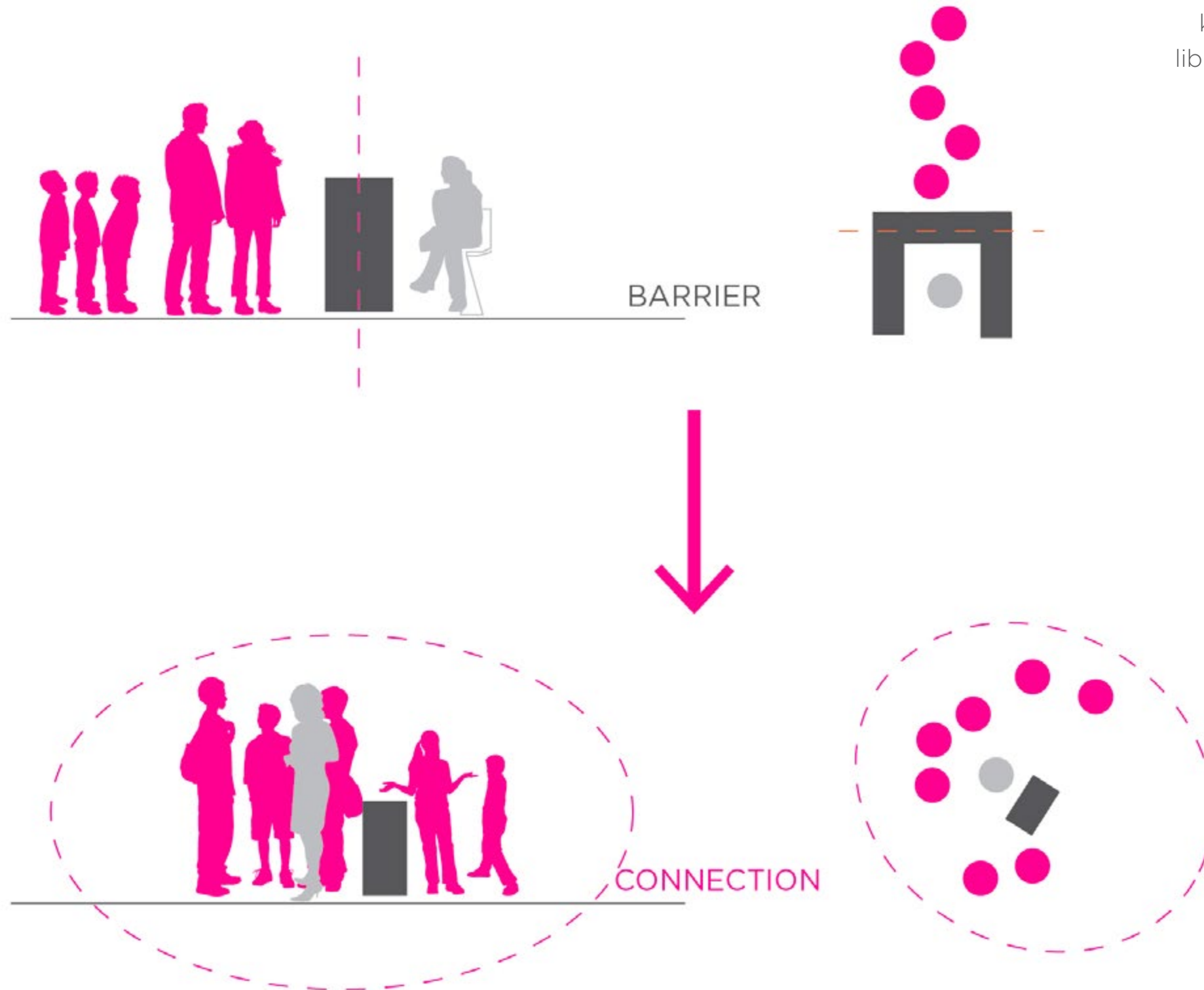

RECONFIGURE

Reconfiguration allows the library to embrace change and continue to find innovative ways to deliver service that supports the shifting needs of the community.

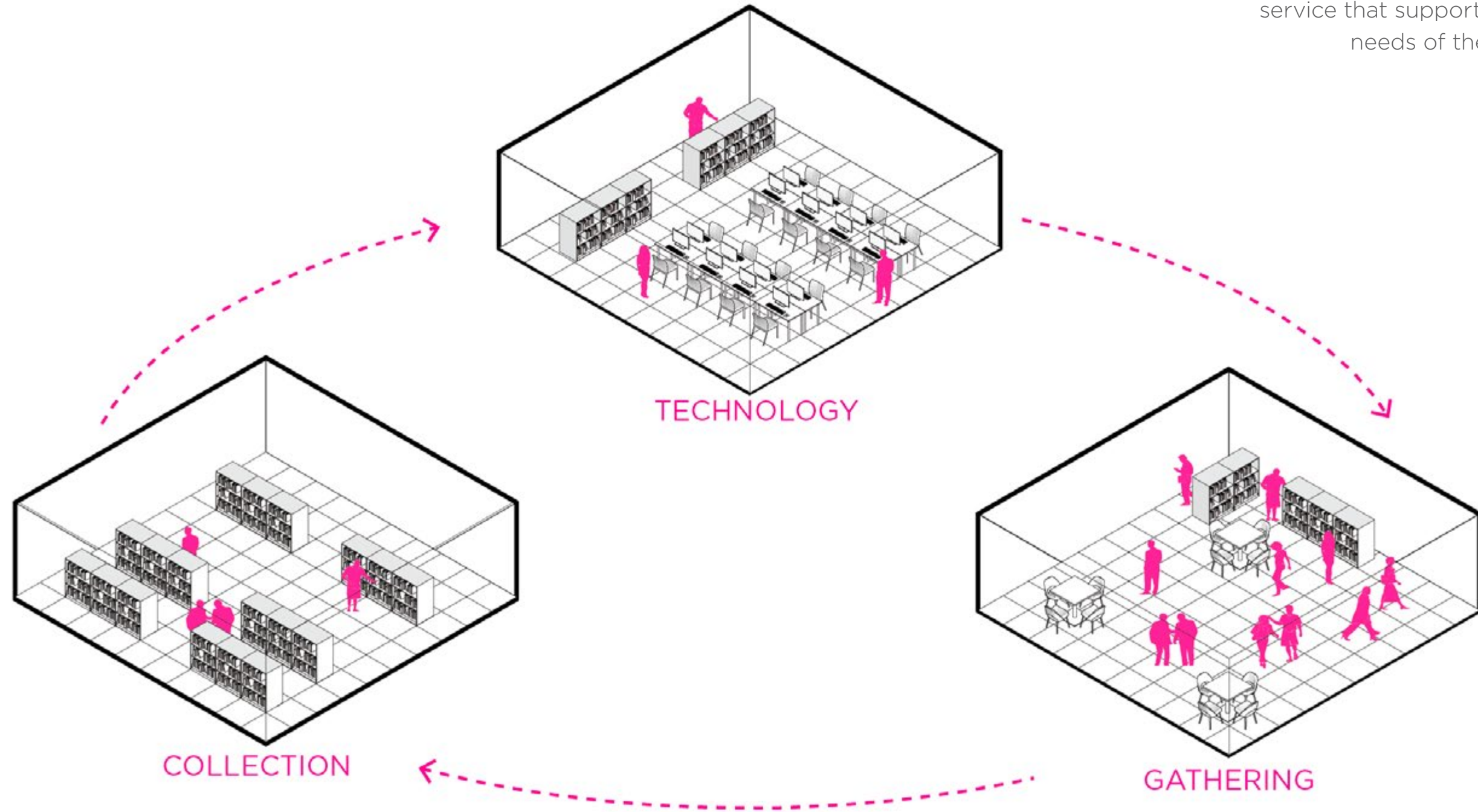

LIBRARIES ARE...

Libraries are **communal space**



Roberta A. Smith University Library | Muskingum University
Architect: Bialosky Cleveland

Libraries are **communal space**



Libraries are **communal space**



Libraries are **social**



Libraries are **social**



ANYTHING
CAN HAPPEN, CHILD,
ANYTHING CAN BE.

TINKER
LAB

Libraries are **refuge**



Libraries are **refuge**

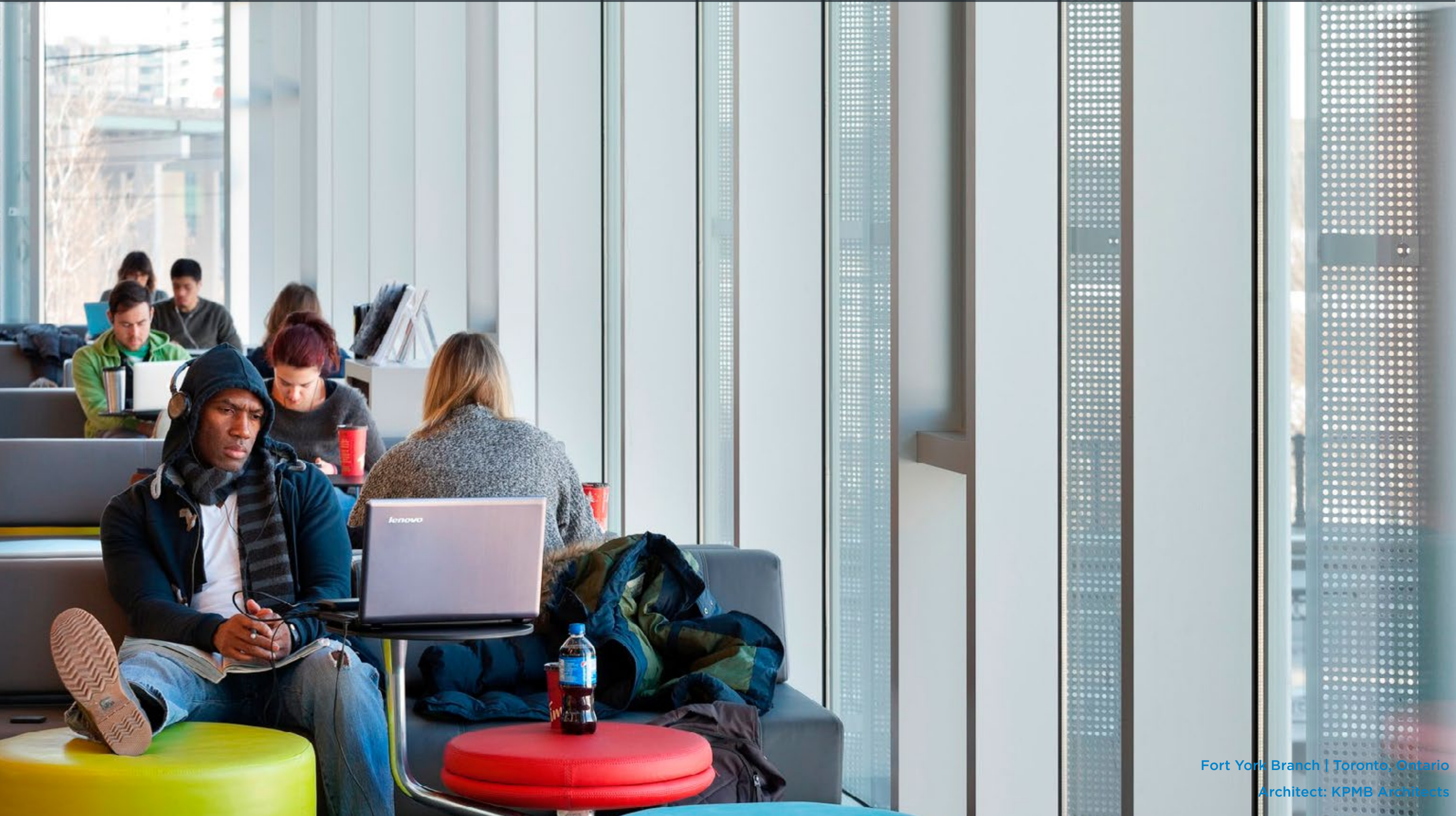

Libraries are **refuge**



Libraries are **flexible**



Libraries are **flexible**



Tacony Library | Philadelphia, PA
Architect: James R. Keller

Libraries are **visible**



Stapleton Branch | Staten Island, NY
Architect: Andrew Berman Architect

Libraries are **visible**



Libraries are **browsable**



Libraries are **browsable**



Klostergarden Public Library | Lund, Sweden
Architect: MDD

Libraries are **browsable**



Libraries are **retail influenced**



Libraries are **retail influenced**



Libraries are **workspace**



Libraries are **collaborative**

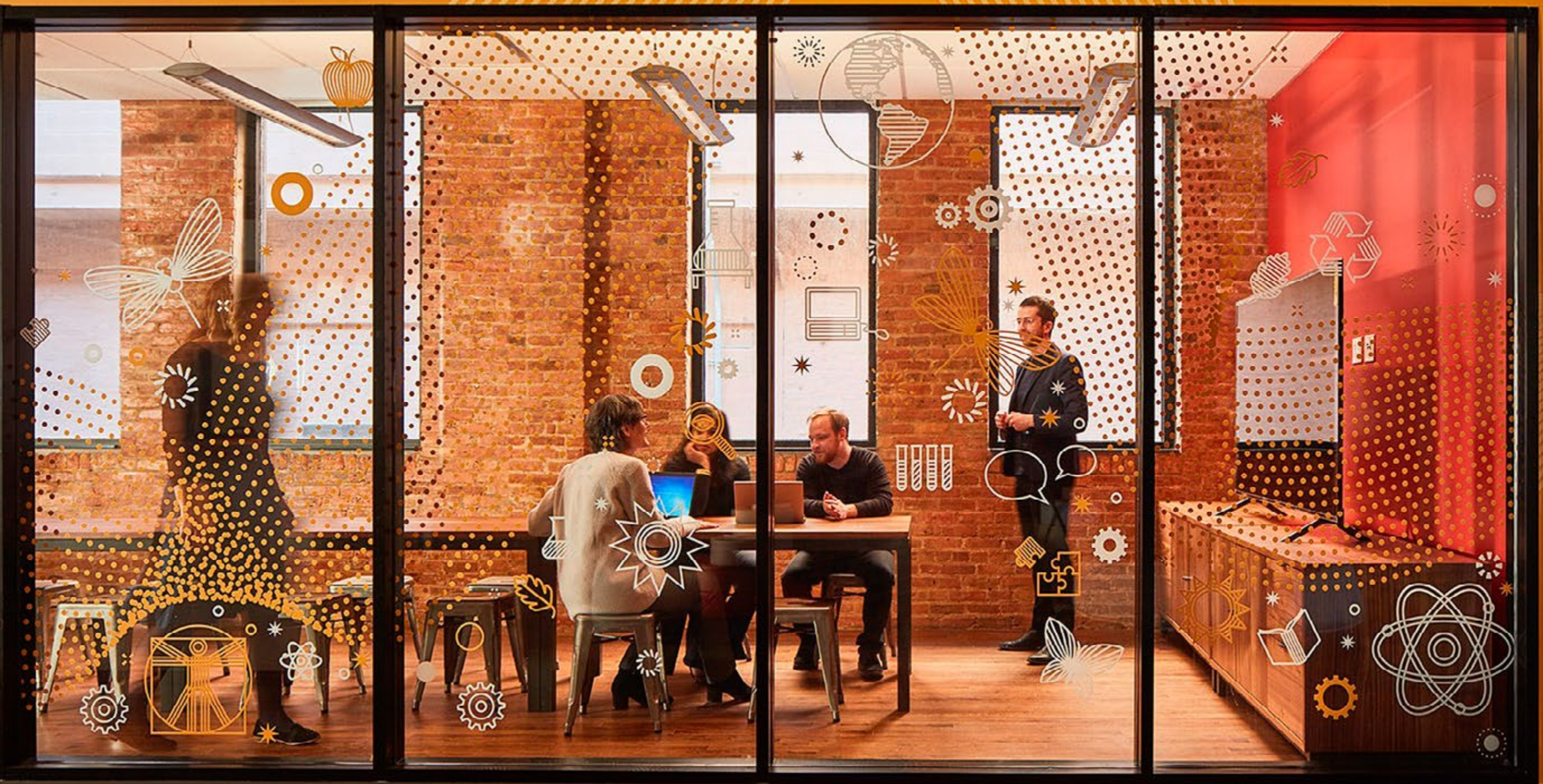

Libraries are **collaborative**



Libraries are **creative**



Libraries are **creative**



Waresville Heights Branch | Waresville Heights, OH

Architect: HBM Architects

Libraries are **learning**

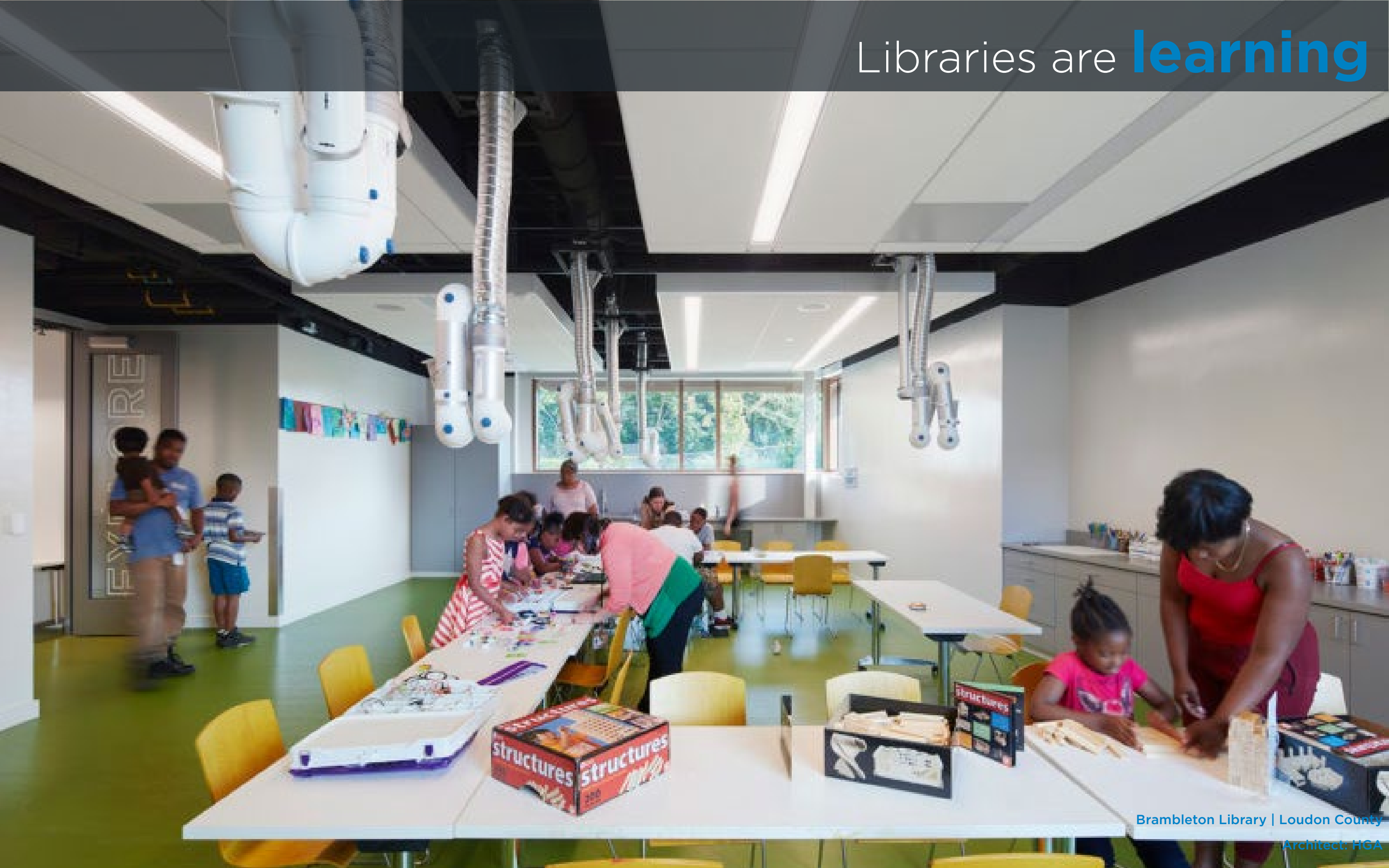

Libraries are **outside**



Albion Branch | Toronto, Ontario
Architect: Perkins & Will

Libraries are **outside**



Libraries are **active**



Libraries are **active**



Libraries are **colorful**

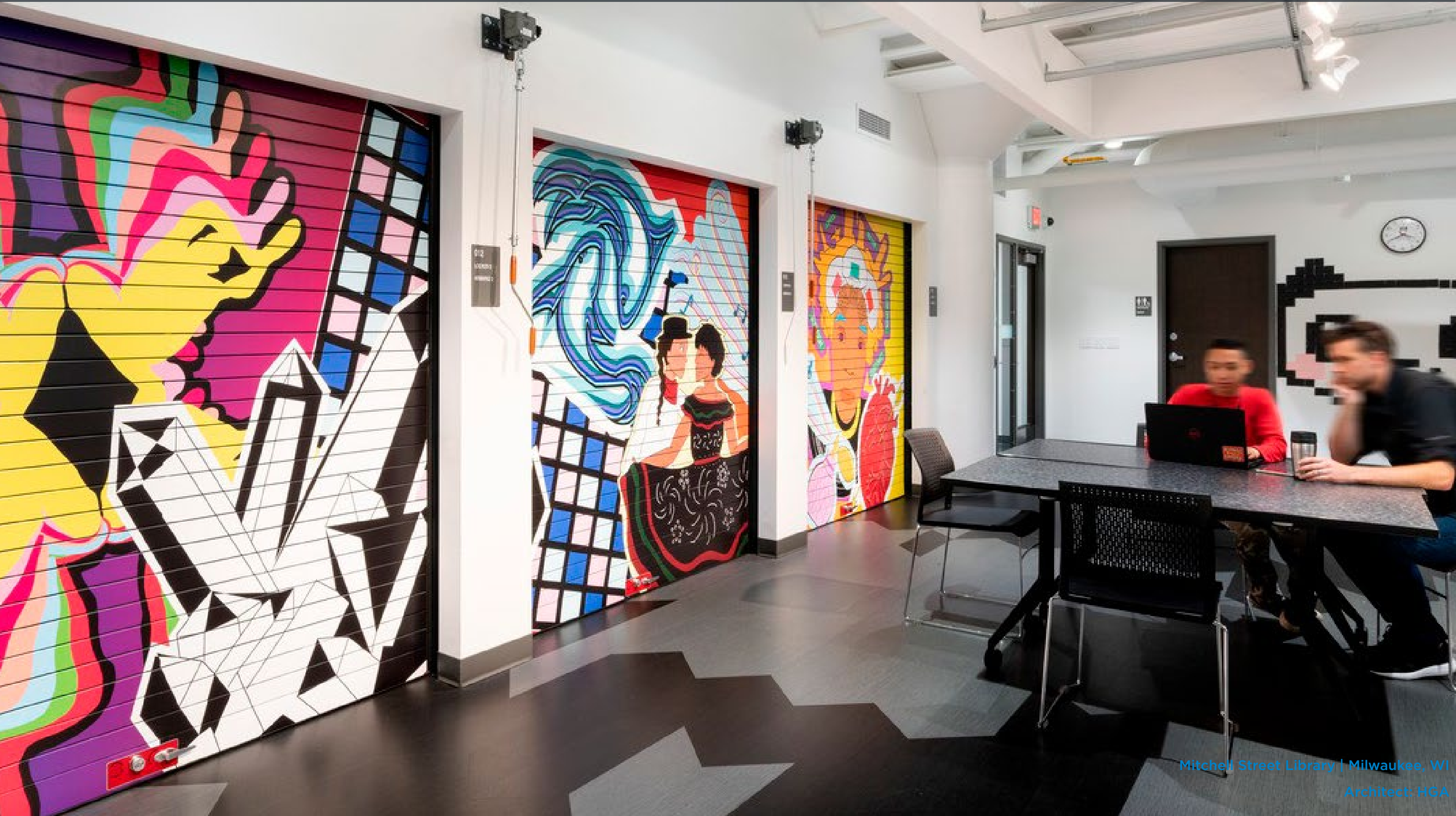

Libraries are colorful



St Louis Main Library | St Louis, MO
Architect: Cannon Design

Libraries are **galleries**

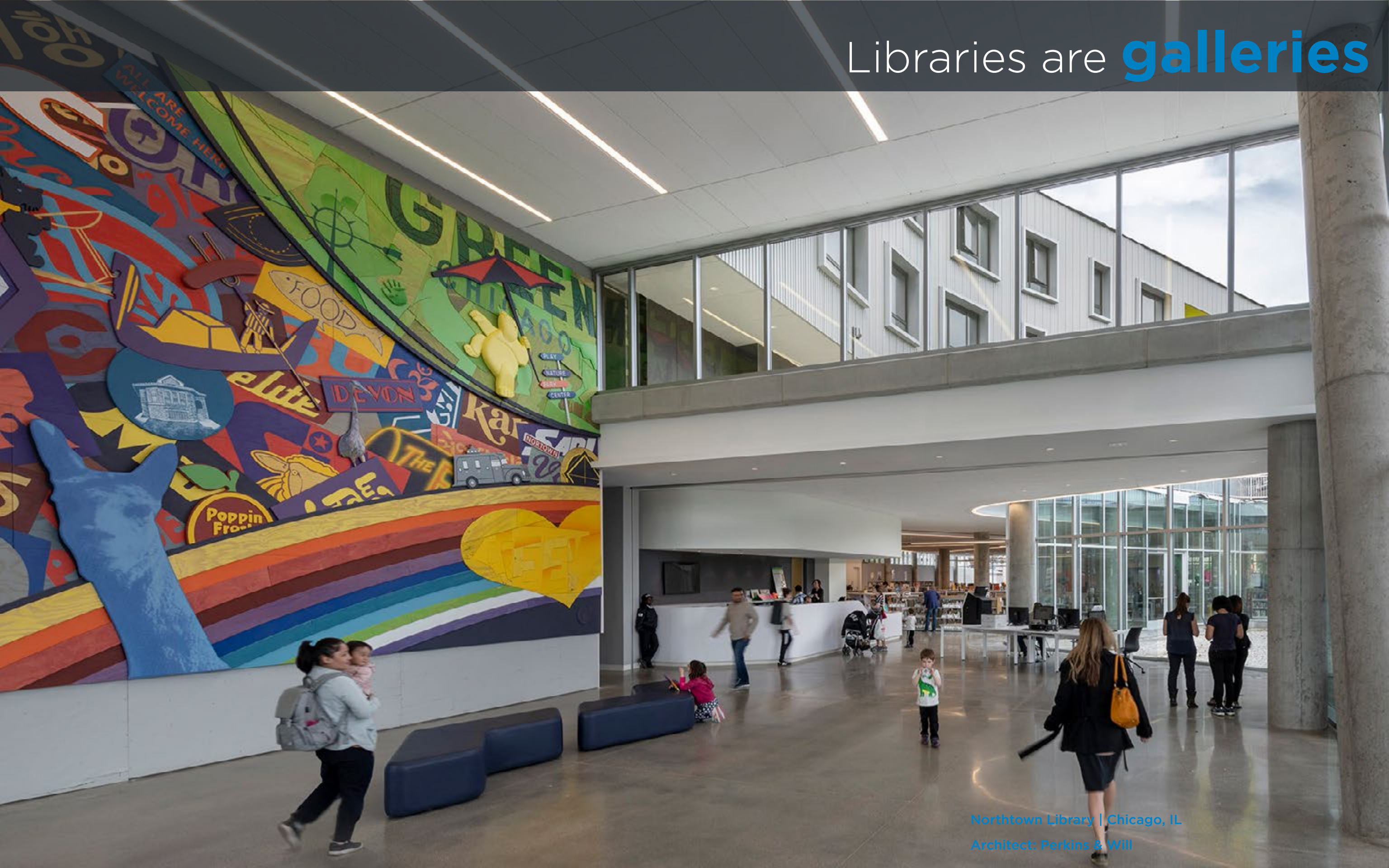

Northtown Library | Chicago, IL
Architect: Perkins & Will

Libraries are **galleries**



Dokk1 | Aarhus, Denmark

Architect: Schmidt, Hammer, Lassen



LIBRARIES ARE...

WHATEVER THEIR COMMUNITY NEEDS THEM TO BE

KEEP LEARNING

Summer Reading List

- Rising to the Challenge: Re-Envisioning Public Libraries

<https://csreports.aspeninstitute.org/Dialogue-on-Public-Libraries/2014/report>



- American Library Association Trends Guide & Quotable Facts

<http://www.ala.org/tools/future/trends>

<http://www.ala.org/advocacy/quotable-facts>



- Palaces for the People: How Social Infrastructure Can Help Fight Inequality, Polarization, and the Decline of Civic Life
by Eric Klinenberg

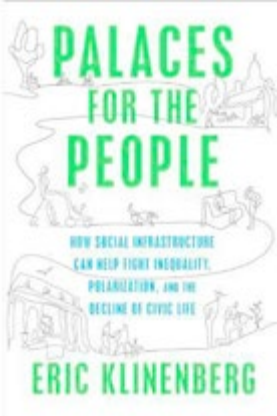



Dayton

Dayton Main Library
Architect: Group 4

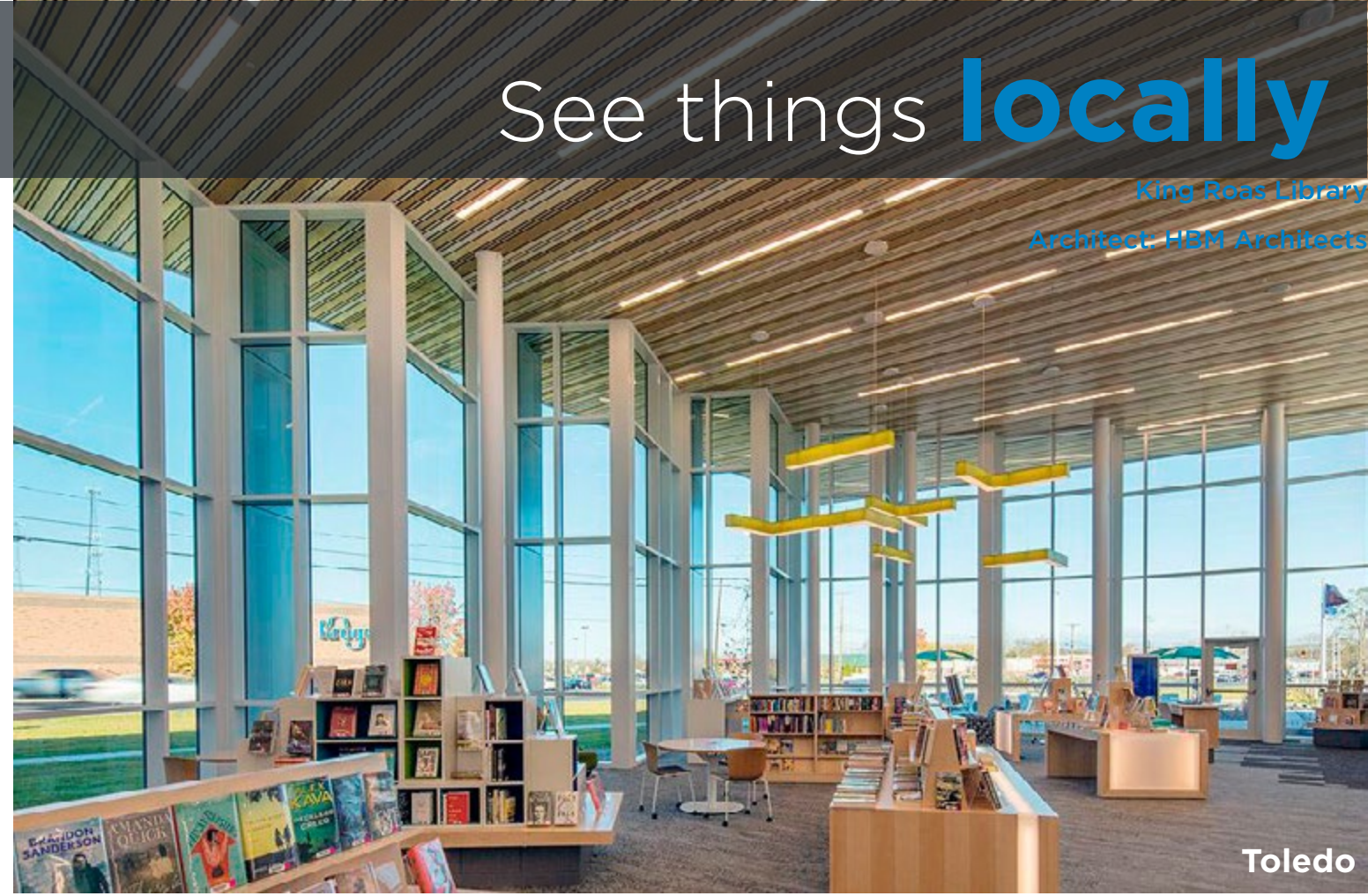

See things **locally**

King Reas Library
Architect: HBM Architects

Toledo



Cuyahoga County

Middleburg Heights Library
Architect: HBM Architects

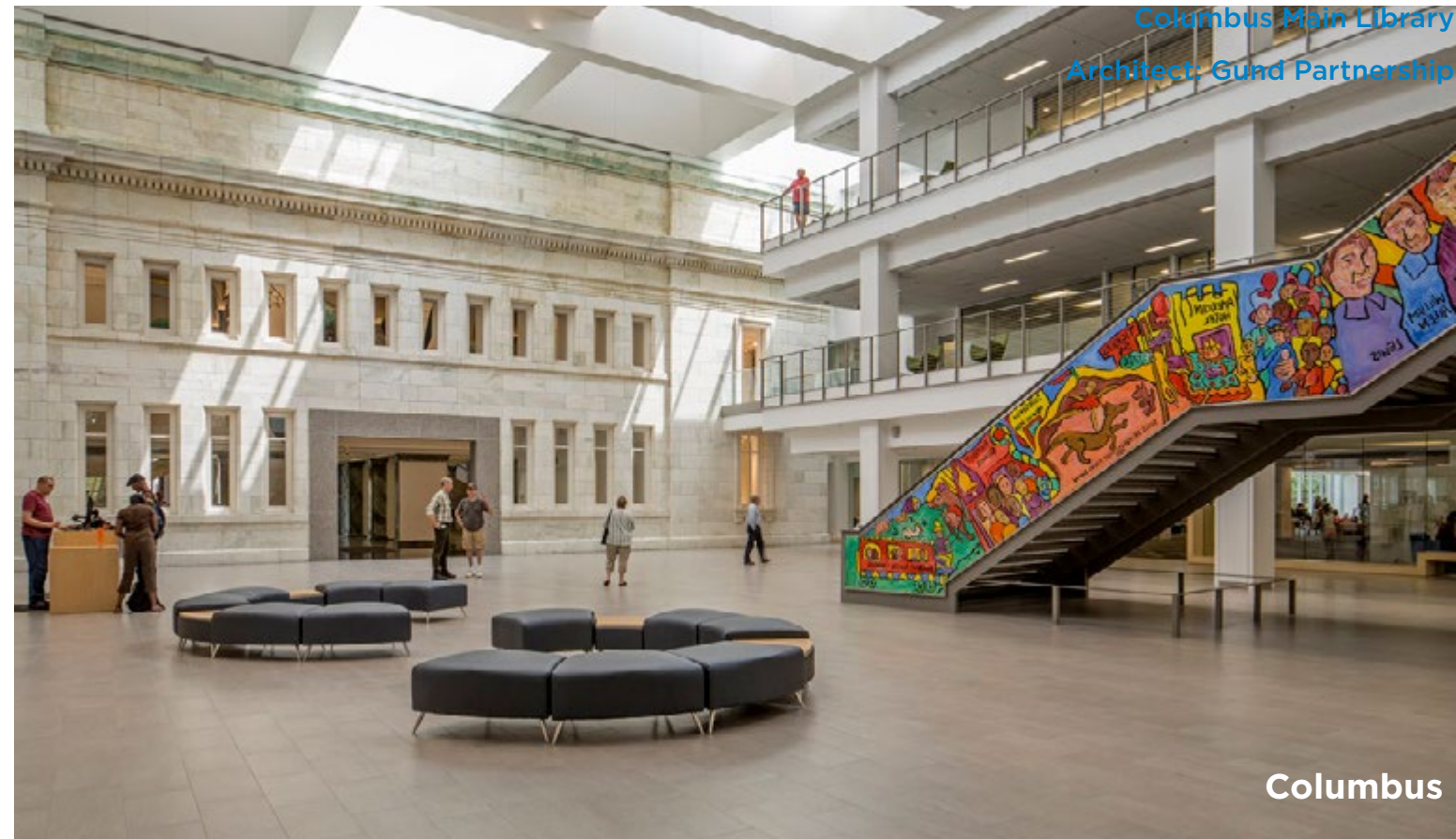

Columbus Main Library
Architect: Gund Partnership

Columbus

See things **regionally**

Southwest Regional Library

Architect: MS&R



Chicago

Chinatown Branch Library
Architect: SOM



Louisville

Albion Branch Library
Architect: Perkins & Will



St. Louis

St. Louis Main Library
Architect: Cannon Design



Toronto

See things **globally**



The Netherlands

LoHal
Architect: Civic Architects

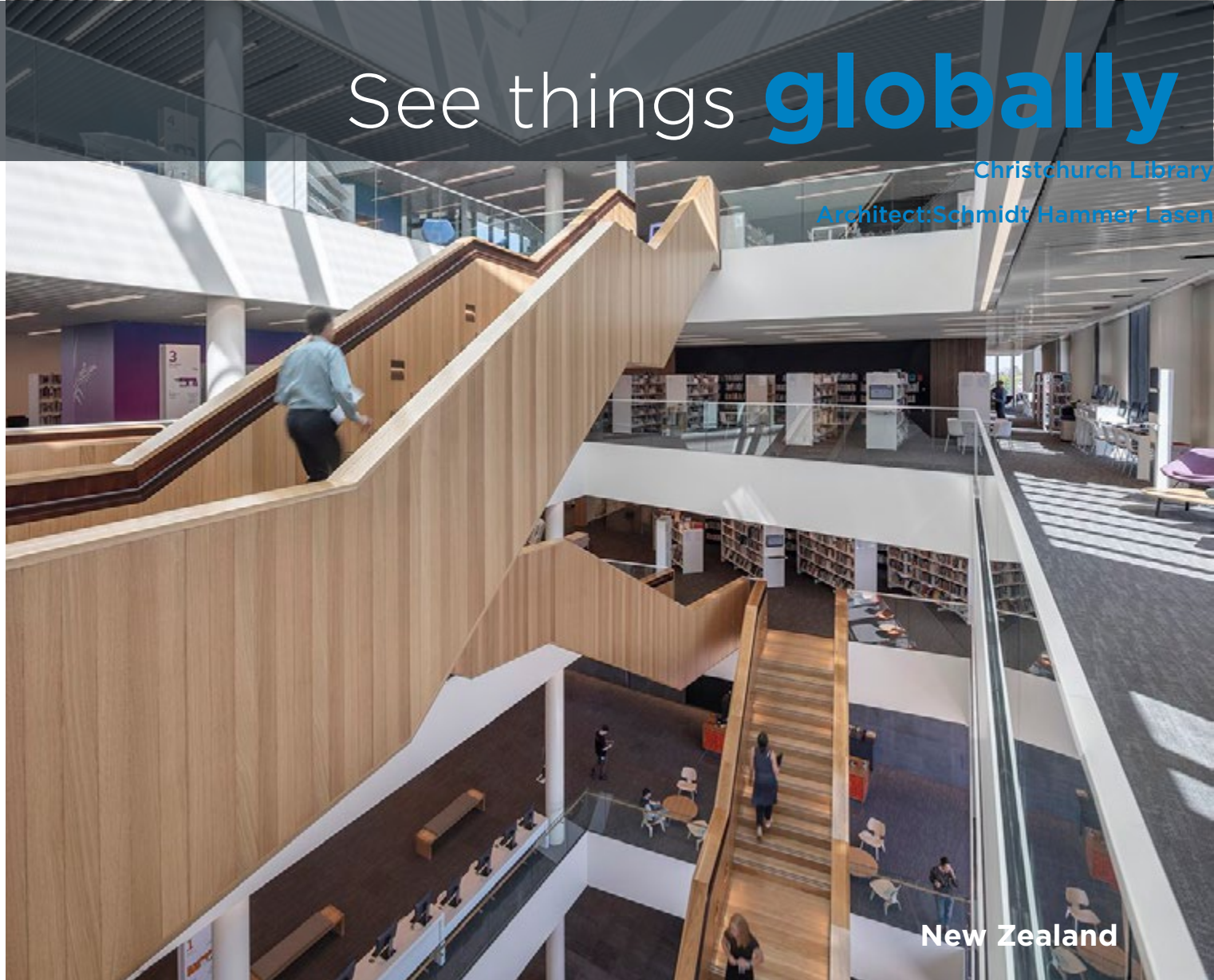

Christchurch Library
Architect: Schmidt Hammer Lassen

New Zealand



Denmark

Dokk1
Architect: Schmidt Hammer Lassen



Calgary Central Library
Architect: Snohetta

Canada

Thank You!

ANY QUESTIONS?